







## SECOND FLOOR

1,328 sq. ft.









## 2-CAR SIDE

447 sq. ft.

Second floor  
stays same size

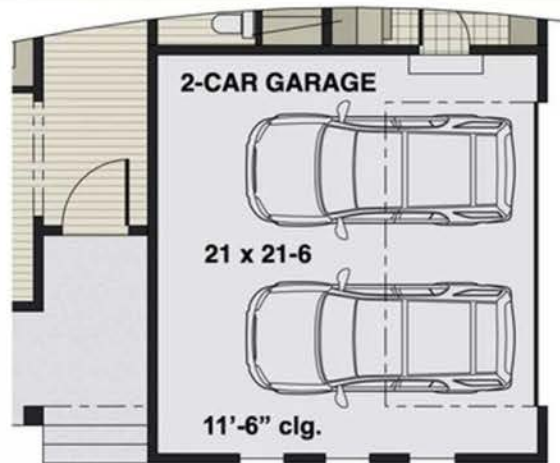



### 3-CAR SIDE

646 sq. ft.

Overall house length  
becomes 70'-0"

Second floor  
becomes  
1,452 sq. ft.

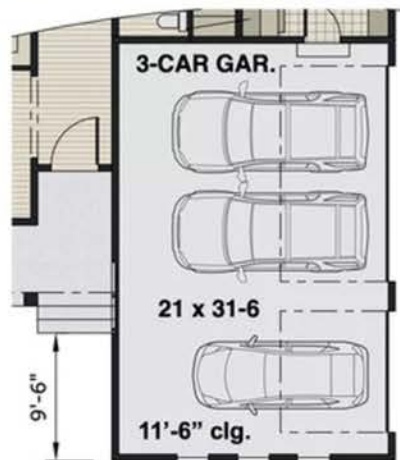



## 3-CAR FRONT

670 sq. ft.

Second floor  
stays same size

House width  
becomes 52'-0"

